



VA.1.26/..

- replaceable flexible insert
- narrow visible surface
- stable aluminium joists
- high-grade steel profile edge

FEATURES

expansion insert can be replaced anytime, abrasion, weather and temperature resistant (-40°C bis +120°C), punched bearing legs guarantee best connection to the subgrade/covering.

APPLICATIONS

shopping centres, railway stations, airports, exhibition halls, residential, office and administration buildings

MATERIAL

aluminium joists with edge profile in high-grade steel, synthetic rubber flexible insert (EPDM)

COVERING TYPES

coating, screed, natural and stone slabs

FORMED PARTS

corner piece, T piece, cross piece

NOTES

In case of mastic asphalt, please request a technical consultation.

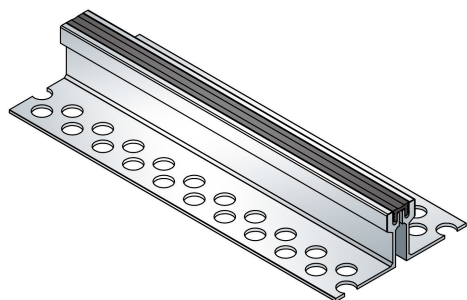

Technical data

Movement horizontal:	4 mm (± 2 mm)
Movement vertical:	2 mm (± 1 mm)
Visible width:	26 mm
Maximal joint width:	20 mm
Load rating:	wheel load 700 kg up to \varnothing 150 mm, B = 100 mm
Supply length:	3 mtr
Color of flexible insert:	black or grey

Designs

Article No.	Profile height (h)	Recess (WxD)
VA.1.26/31	31 mm	160 x 41 mm
VA.1.26/46	46 mm	160 x 56 mm
VA.1.26/61	61 mm	160 x 71 mm

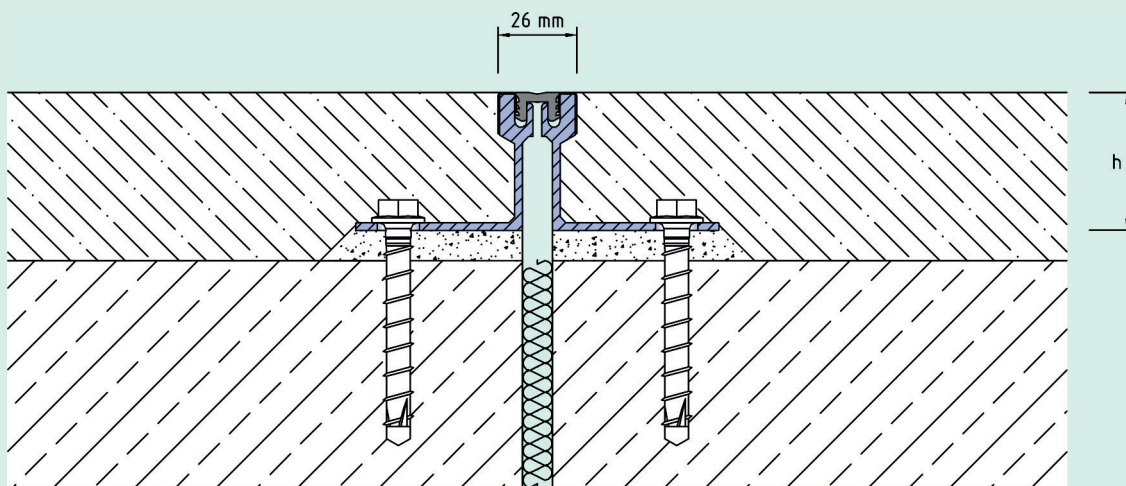

VA.1.26

Subject to technical change without notice.