

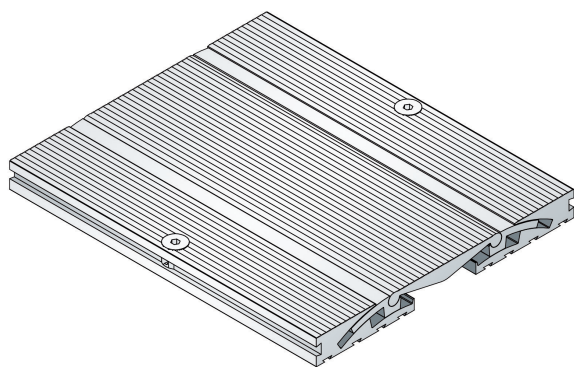

## AL.5.210/20

- for normal loads
- low profile height
- three-dimensional absorption of movements
- solid full-aluminium structure



### FEATURES

resistant to heavy loads, trafficable by fork-lift trucks, the special profile design means that no bearing leg slips under the floor covering (this prevents thin industrial floor coverings from tearing)

### APPLICATIONS

all industrial applications, shopping centres, railway stations, airports, exhibition halls

### MATERIAL

aluminium

### COVERING TYPES

coating, concrete, screed, industrial covering, natural and stone slabs

### TRAFFICABILITY

industrial trucks (lifting trucks, fork-lifts etc.), passenger car, trucks

### FORMED PARTS

corner piece, T piece, cross piece

### NOTES

We recommend that the customer applies grout between profile and covering so as to avoid typical hairline cracks.

### Technical data

Movement horizontal:	30 mm (-10/+20 mm)
Movement vertical:	10 mm ( $\pm 5$ mm)
Visible width:	210 mm
Maximal joint width:	50 mm
Load rating:	wheel load 1000 kg up to $\varnothing$ 150 mm, B = 100 mm
Load rating trucks:	300 kN (DIN 1072)
Load rating forklifts:	70 kN (DIN 1055-3)
Supply length:	3 mtr

### Designs

Article No.	Profile height (h)	Recess (WxD)
AL.5.210/20	20 mm	350 x 30 mm

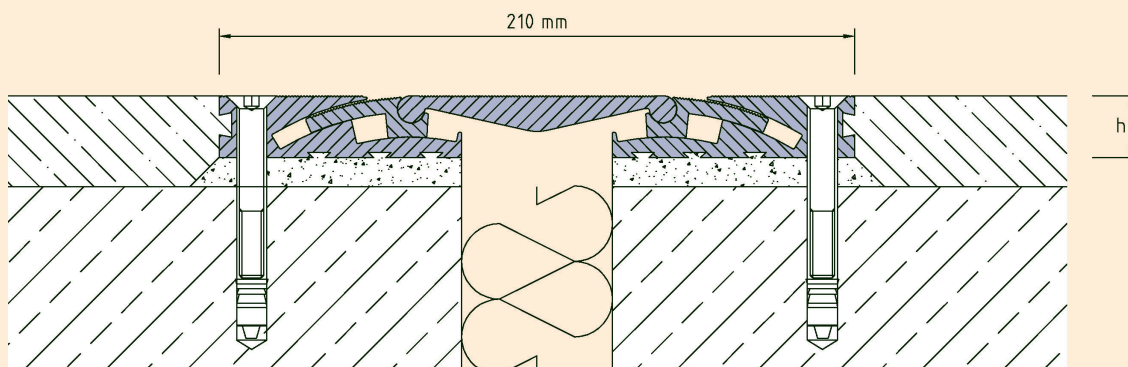

AL.5.210

Subject to technical change without notice.